

**Lupo**  
Made in Italy

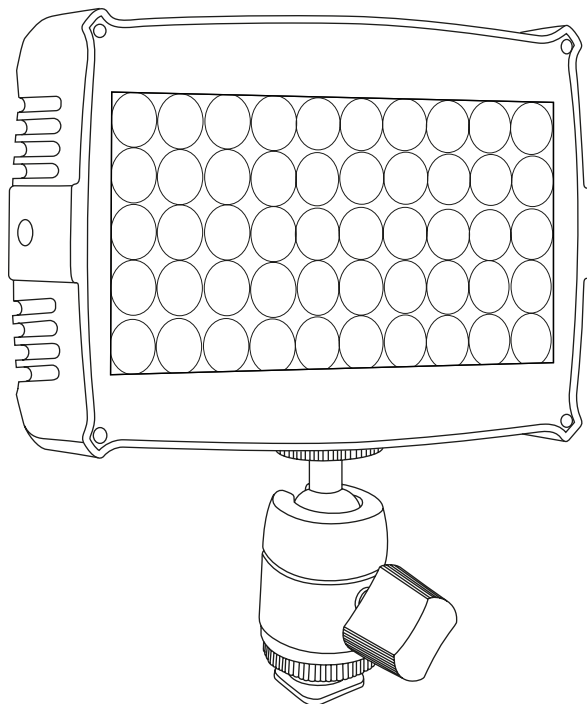

# **Kickasspanel FULL COLOR**

---

**User Manual**

---

## **PLEASE NOTE:**

This manual is valid from 3.6 firmware version.

### **SAFETY PRECAUTIONS:**

Do not operate the equipment before studying the instruction manual and the accompanying safety precautions. Make sure that Lupo Safety Instruction is always included with the equipment! Lupo products are intended for professional use. Do not place or use the equipment where it can be exposed to moisture, extreme electromagnetic fields or in areas with flammable gases or dust! Do not expose the equipment to hasty temperature changes in humid condition as could lead to condensation water in the unit. Equipment must only be serviced, modified or repaired by authorized. Dealers or the factory.

### **CAUTION - BURN HAZARD - HOT PARTS**

Do not touch hot parts with bare fingers! LED bulbs and certain metal parts emit strong heat when used!

Do not point lamps too close to persons. Always use the fixtures with the front part closed.

### **NOTICE - EQUIPMENT OVERHEATING RISK**

Do not obstruct ventilation by placing filters, diffusing materials, etc. over inlets and outlets of the equipment ventilation or directly over glass cover or LED bulbs.

### **FINAL DISPOSAL**

Equipment contains electrical and electronic components that could be harmful to the environment.

Equipment may be returned to Lupo distributors free of charge for recycling

according to WEEE. Follow local legal requirements for separate disposal of waste, for instance WEEE directive for electrical and electronic equipment on the European market, when product life has ended.

### **MAINTENANCE AND CARE**

Please do not forget that the safe operation of lampheads also includes their maintenance and care.

A visual inspection should be conducted before every use and an inspection of electrical safety should be conducted at least once every 12 months.

### **WARRANTY**

The warranty period for Lupo products and those marketed by Lupo is twelve months from the date of delivery. Lupo guarantees that the goods it supplies are well manufactured and of good quality. The warranty guarantees the repair of any parts that show acknowledged defects in materials, construction or workmanship during the warranty period. The guarantee excludes any liability for direct or indirect damage of any kind and for any reason, for which Lupo will therefore not be required to pay compensation. The customers shall see to delivering the parts that need repair or replacement to Lupo's works at their own expense and risk. The repaired or replacement parts shall be delivered by Lupo ex-works. The customers will be charged for materials and labor or replacement of the product after the expiration of the warranty period.

*Thanks for having purchased **Lupo** products. All the products are made in Italy and all the efforts have been put to keep the quality standards high. We hope this product can help you in your job and make your life easier as a professional. We also hope you will enjoy its use and we would be happy to receive your feedback about it.*

## Instructions

- Device for indoor use only.
- Maximum ambient temperature: 35 °C.
- Make sure power supply plug is suitable for power required.
- To switch on the light push the on/off button.
- Kickasspanel model are equipped with new generation high quality poweredleds.

**ATTENTION:** when the C type cable is connected, and the unity is powered by Type C cable, the power is 50%.

## Package Contents

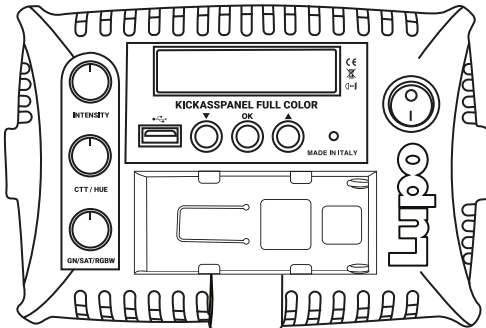

**Kickasspanel**

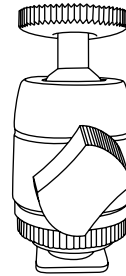

**Stand and camera adapter**

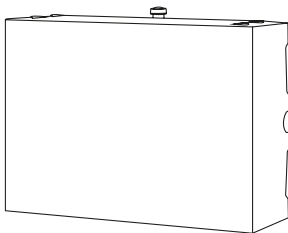

**Diffuser**

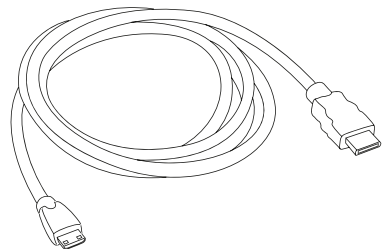

**USB cable**

## Switching on the Kickasspanel

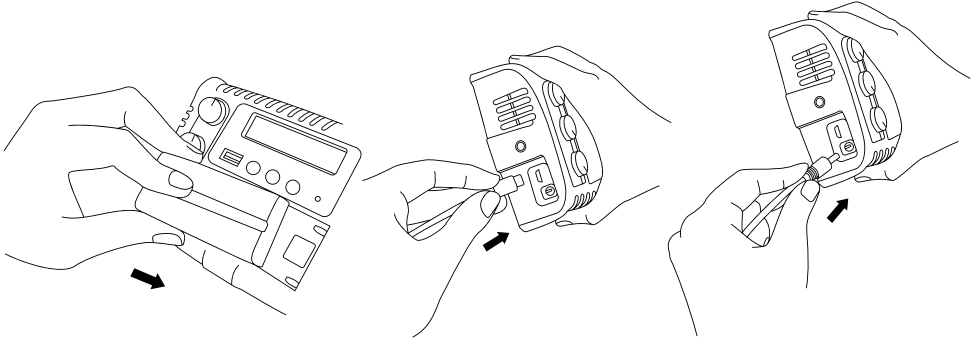

**1 For battery use:**  
insert the battery (not included) and switch ON the unit.

**2 For use with USB cable:** insert the USB cable in the USB port and switch ON the unit.  
Power supply only min 2A

**3 For use with DC Adapter Connection:** insert the Adapter Connection in the DC port and switch ON the unit.

## Getting Started

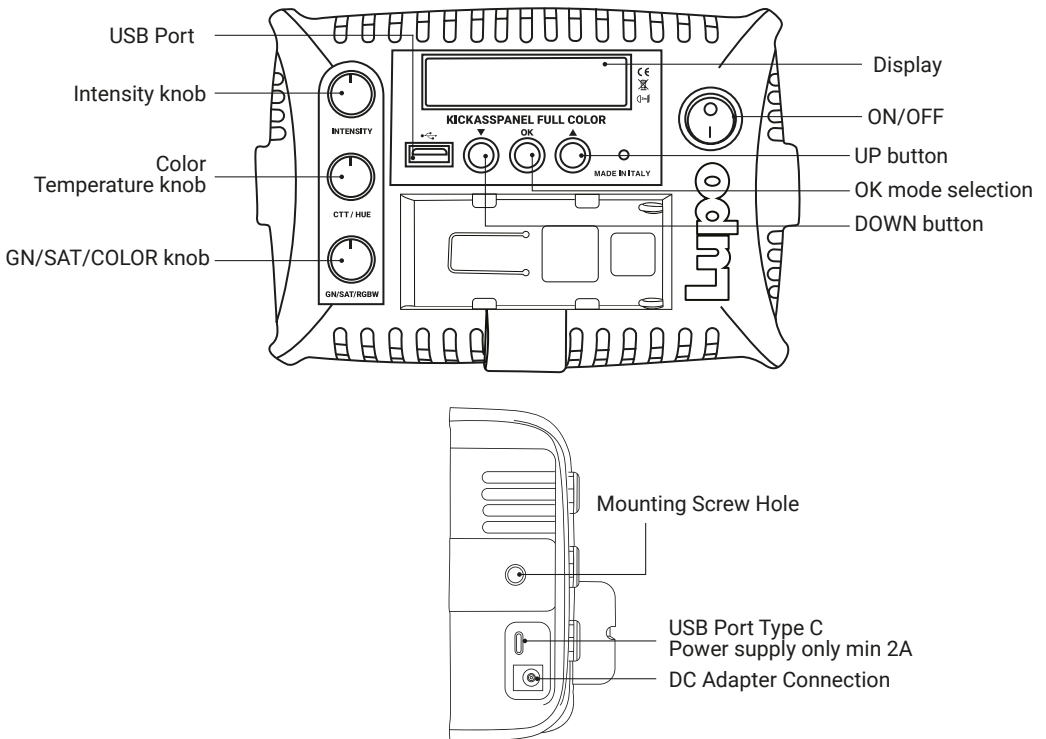

## CONTROL PANEL

- In current mode press the « OK » ② button to enter the main MENU.
- In the sub-menus press the « OK » ② button to confirm a selection.
- Use the « ▼ » ① or « ▲ » ③ buttons to navigate in the main MENU and sub-menus.
- Use the « INTENSITY » ④ knob to adjust the *light intensity from 0 to 100%*.
- Use the knobs ⑤ and ⑥ to adjust the light mode parameters.
- Display ⑦.

## MANUAL OPERATION

1. Press the « OK » ② button to enter the main MENU.
2. Select **MANUAL** by pressing the « OK » ② button.
3. Select the light mode between **CCT / HSI / RGBW / PRESET / EFFECT** with the « ▼ » ① or « ▲ » ③ button, press « OK » ② to confirm selection.
4. See *LIGHT MODES*.

## LIGHT MODES

MODE	INTENSITY ④	CCT/HUE ⑤	GN/SAT/COLOR ⑥	« ▼ » ① « ▲ » ③
CCT	Light Intensity from 0 to 100%	CT 2800K to 10000K	GN -1.00 to +1.00	-
HSI		HUE 0° to 100°	SAT 0 to 100%	-
RGBW		-	Select function R/G/B/W/CT/GN	Change values of the function
PRESET		-	-	Change Preset
EFFECT		"See EFFECT table"	"See EFFECT table"	Change Effect

**A. CCT MODE:** Warm and cold white control mode. It allows you to adjust colour temperature (CCT), green/magenta compensation (GN) and light intensity. *This is the default setting*

**B. HSI MODE:** Colour composition mode. It allows you to adjust hue of colour (HUE), colour saturation (SAT) and light intensity.

**C. RGBW MODE:** RGBW colour control mode allows to individually set the R, G, B, W, Color Temperature (CT), green/magenta compensation (GN) values and to adjust light intensity

**D. PRESET MODE:** Mode with 53 PRESET colors, 48 factory preset and 5 user-defined preset.

1. In MANUAL OPTIONS menu select **PRESET MODE**.
2. Select the PRESET to be activated with the « ▼ » ① or « ▲ » ③ buttons, confirm the selection by pressing the « OK » ② button.
3. In current mode, use the « ▼ » ① or « ▲ » ③ button to change the PRESET in ascending or descending order. **THE PRESET ON THE DISPLAY IS THE SELECTED PRESET.**
4. Use the « INTENSITY » ④ knob to adjust the *light intensity from 0 to 100%*.

### SAVING THE SET VALUES AS A PRESET

You can store up to **5 PRESETS**.

1. In CCT / HSI / RGBW mode, press the « ▼ » ① and « ▲ » ③ at the same time.

- Save the set values in one of the available presets between **USER PRESET 1 / 2 / 3 / 4 / 5** press the « ▼ » ① or « ▲ » ③ button to select the PRESET number and press « OK » ② to confirm the selection. **THE SET COLOR IS SAVED AS PRESET.**

"**BUSY**" indicates that in the user preset there are parameters memorized if you select it, the parameters will be replaced by the new ones. "**EMPTY**" indicates that the user preset is free.

**E. SPECIAL EFFECT MODE:** Mode with 10 SPECIAL EFFECTS. **STROBE / PARTY / COPCAR / DISCO / TELEVISION / PAPARAZZI / LIGHTNING / EXPLOSION / FIREWORKS / FIRE.**

- In MANUAL OPTIONS menu select **EFFECT MODE**.
- Select the EFFECT to be activated with the « ▼ » ① or « ▲ » ③ buttons, confirm the selection by pressing the « OK » ② button.
- In current mode, use the « ▼ » ① or « ▲ » ③ button to change the EFFECT in ascending or descending order. **THE EFFECT ON THE DISPLAY IS THE SELECTED EFFECT.**
- Use the knobs ⑤ and ⑥ to adjust the effect setting values. **See table below.**

**⚠ ATTENTION - Only to STROBE effect**

- The strobe effect is **AVaiLABLE ONLY IN MANUAL OPERATION.**
- The strobe effect is applied to the parameters of the last configured CCT/HSI/RGBW/PRESET mode.
- The STROBE effect is **NOT WORK** if PARTY, COPCAR, DISCO, TELEVISION, PAPARAZZI, LIGHTNING, EXPLOSION, FIREWORKS or FIRE effects are in functioning.

EFFECT	④ INTENSITY knob	⑤ CCT/HUE knob	⑥ GN/SAT/COLOR knob
STROBE	Light Intensity from 0 to 100%	Frequency - 1 to 25 Hz	-
PARTY		Speed - 0 to 100%	-
COPCAR		Flash Color - B / R / R+B / B+W / R+B+W	N° flashes for cycle - 1 to 4
DISCO		Speed - 0 to 100%	-
TELEVISION		White range - 1 / 2 / 3 / 4	Frequency - 4 to 24 Hz
PAPARAZZI		Flashing Interval - 1 to 10	Bulb type - 0 / 1 / 2
LIGHTNING		Color Temperature	Lightnings Interval - 1 to 20
EXPLOSION		Speed - 1 to 60	-
FIREWORKS		Speed - 1 to 60	-
FIRE		Speed - 1 to 3	-

**DEVICE SETTINGS**

- Press the « OK » ② button to enter the main MENU.
- Navigate through the MENU using the « ▼ » ① or « ▲ » ③ buttons, select **DEVICE SETTINGS**, press the « OK » ② button to confirm the selection.
- Navigate through the **FAN / DISPLAY / MENU VIEW / FILTER / LINEARIZATION / CCT LIMIT** functions, use the « ▼ » ① and « ▲ » ③ buttons to select the desired function and press « OK » ② to confirm the selection.
- Within each function select the option to be activated, use the « ▼ » ① and « ▲ » ③ buttons to select one between the options, press « OK » ② to activate it.

**Display:** Time during which the display backlight stays on. **30sec / 1min / ALWAYS ON.**

**Filter:** It is the speed response of the system (smooth factor).

**FULL SPEED / NORMAL SPEED / HIGH SPEED / LOW SPEED.**

**Linearization:** Linearization is the compensation curve for the human eye's perception of the luminous intensity emitted as a function of the required power. Required power = dimmer value on the display. **LINEAR / EXPONENTIAL / LOGARITHMIC.**

**Linear:** No compensation, the intensity of the light is directly proportional to requested power.

**Exponential:** The light intensity increases from 0 to 100 exponentially.

**Logarithmic:** The light intensity increases from 0 to 100 logarithmically.

**CCT Limit:** The colour temperature is limited. **3200K - 5600K / 2800K - 10000K.**

## RESET DEVICE

1. Press the « OK » **2** button to enter the main MENU.
2. Select **RESET DEVICE** using the « ▼ » **1** or « ▲ » **3** buttons, press the « OK » **2** button to confirm the selection.
3. Select **YES** with the « ▼ » **1** or « ▲ » **3** buttons, press « OK » **2** to confirm the selection.
4. The device will ask for further confirmation, select **YES** by pressing the « OK » **2** button. **THE DEVICE WILL RETURN TO FACTORY DEFAULT SETTINGS.**

## FACTORY DEFAULT SETTING

### MANUAL OPERATION

MODE: CCT

### DEVICE SETTINGS

DISPLAY: 1 min

FILTER : Normal speed

LINEARIZATION: Linear

CCT LIMIT: 2800K - 10000K.

## USB port

Use USB port for firmware updates.

# MENU e submenus

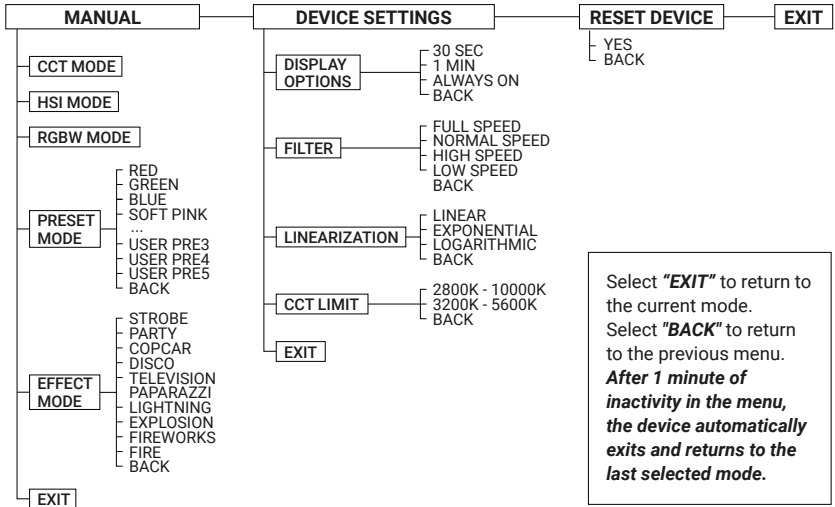

# Accessories

The accessories are products sold separately.

**2**



## 2 Battery

Battery option 1: NP-F-SERIES (7.4 V)

Battery option 2: V-Mount type (14.8 V)

**3**

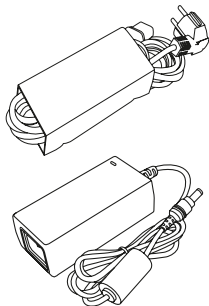

## 3 AC Power Cord Cable and AC Adapter (cod. 752)

AC input: 100 V - 240 V DC output: 24 V

**Attention: DC center pin must be positive.**